

# VSSD48-10

## STAINLESS STEEL EXHAUST HOOD N.S.F. LISTED. CONFORMS TO NFPA96

Hood Constructed with continuous liquid-tight weld in conformance to IMC 2012 507.7.1.

Hood material: 18 Gauge 430 STAINLESS STEEL (#3 polish) where exposed.

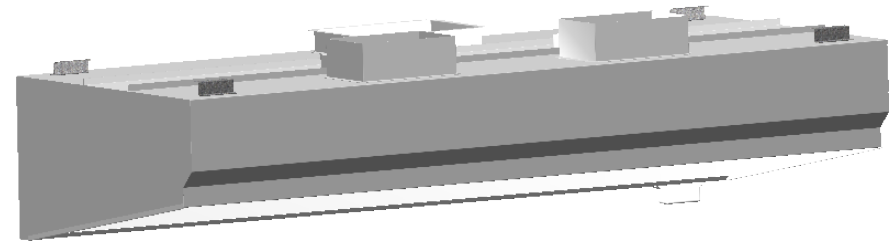
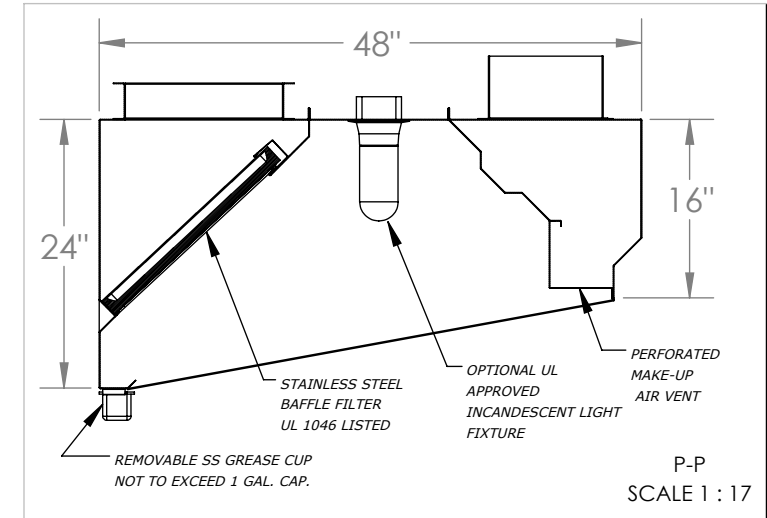
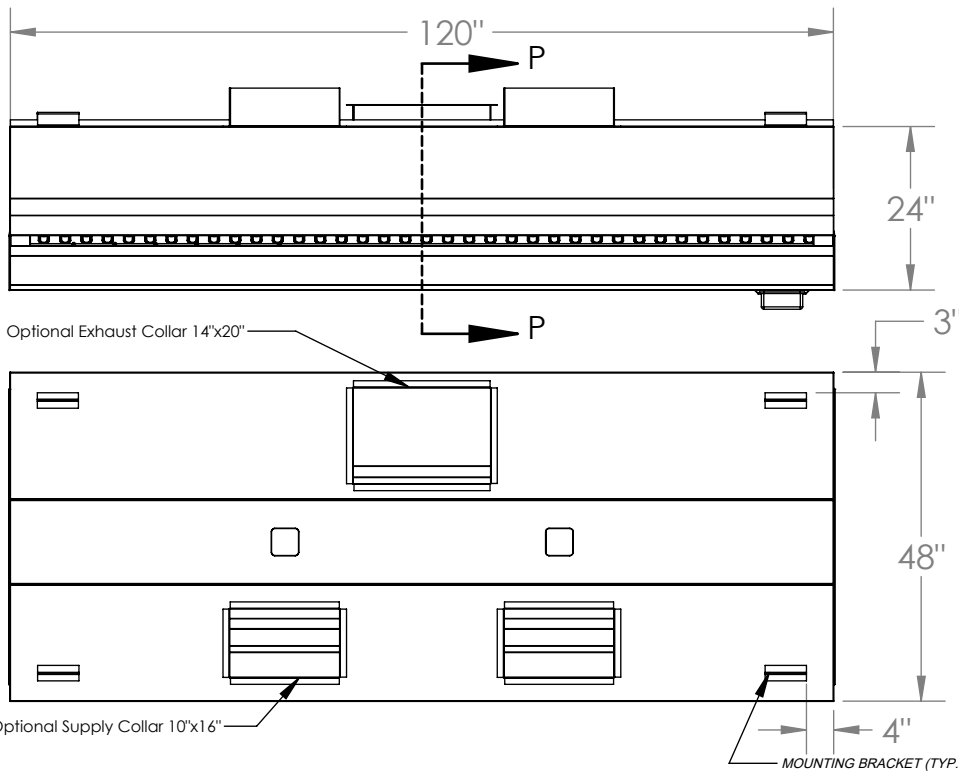

### MODEL INFORMATION

TYPE	DIMENSIONS			CFM SPECS		WEIGHT
	LENGTH	WIDTH	HEIGHT	EXHAUST PLENUM	SUPPLY PLENUM	
1	120"	48"	24"	3021 @ 0.5 ESP	2417 @ 0.12 ESP	293 lbs

OBS.: Installing contractor have the responsibility to ensure hood clearance from limited-combustible and combustible materials is compliant with local code requirements.

### STANDARD COMPONENTS

MOUNTING BRACKET 12-GAUGE GALVANIZED	Grease Drain	Grease Cup Stainless Steel NSF	Grease Filter Stainless Steel UL 1046		
QTY	QTY	QTY	QTY	Length	Height
4	1	1	0	16"	20"
			1	20"	20"
			4	25"	20"

### SUGGESTED COMPONENTS

Exhaust Collar	Supply Collar (Built-in Fire Damper)		Standoff	Incandescent Light Fixture	Shipping Crate	
	Size	QTY			Dimensions (in) and Weight (lb)	Length:
16-Gauge Cold Rolled Build	16-Gauge Cold Rolled Build		<input type="checkbox"/> NONE <input type="checkbox"/> 3" <input type="checkbox"/> _____	UL Listed (Included Component)	Length:	124"
QTY	Size	QTY			Size	Width:
1	14" x 20"	2	10" x 16"	QTY	Height:	32"
				2	Weight:	393 lbs



PO BOX 47607 - ATLANTA, GA 30360  
PHONE: 770.936.0770 - www.superiorhoods.com

PROJECT

VSSD48-10

TITLE

VSSD HOOD MODEL STANDARD  
SPEC SHEET

APPROVED

SIZE

CODE

DWG NO

REV

CHECKED

B

01

DRAWN

PRODUCTION

2023

SCALE: 1:28

WEIGHT: 293 lbs

SHEET: 1/1